

A.B.C.D. Part of a Large Tract Surveyed for the Company in 1716 & 1717 by Isaac Taylor.

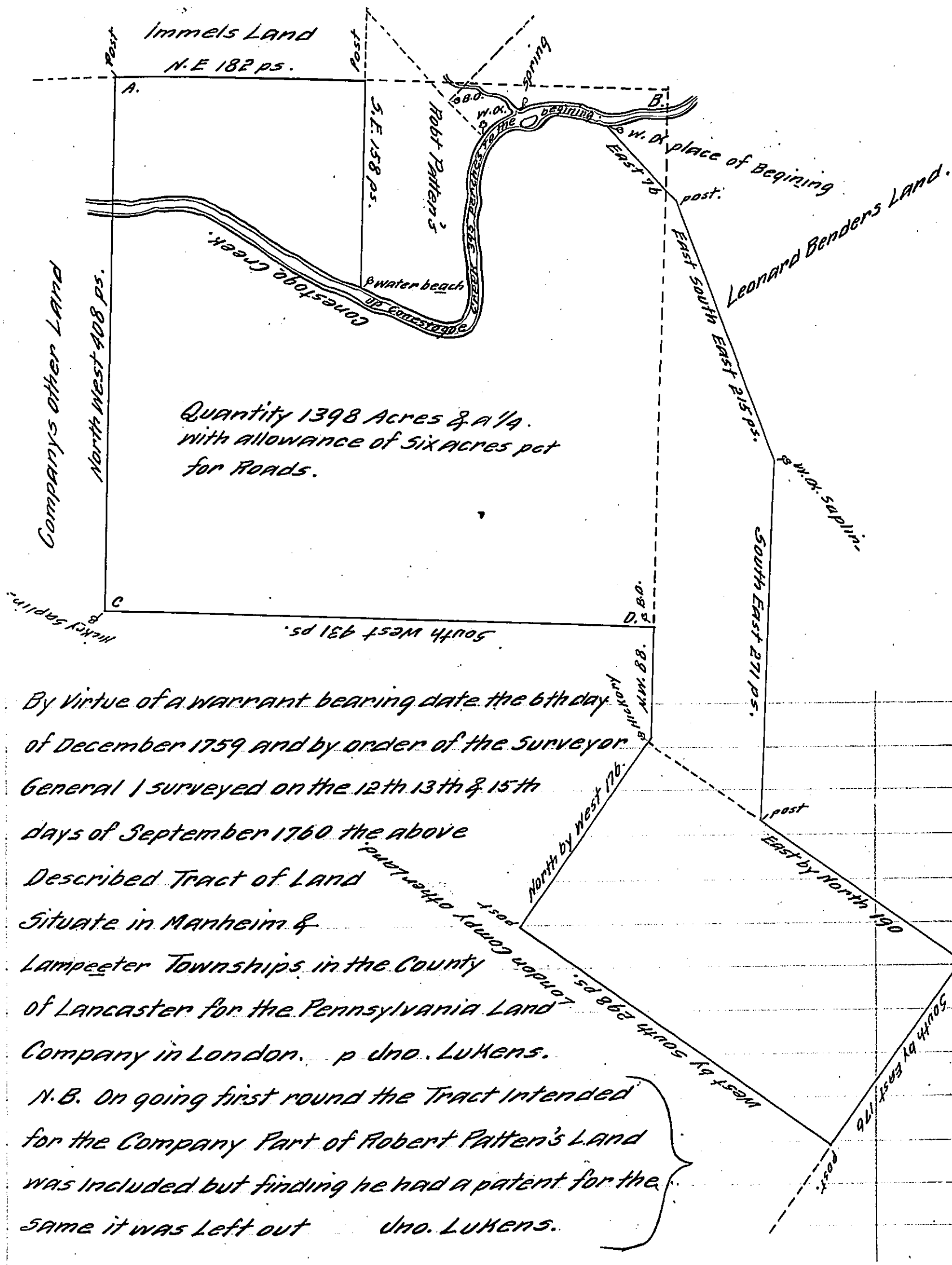

By virtue of a warrant bearing date the 6th day
of December 1759 and by order of the Surveyor
General I surveyed on the 12th 13th & 15th
days of September 1760 the above
Described Tract of Land
Situate in Manheim &
Lampeeter Townships in the County
of Lancaster for the Pennsylvania Land
Company in London. p dno. Lukens.

N.B. On going first round the Tract intended
for the Company Part of Robert Patten's Land
was included but finding he had a patent for the
same it was Left out dno. Lukens.

IN TESTIMONY that the above is a copy of the original remaining on file in
the Department of Internal Affairs of Pennsylvania, made
conformably to an Act of Assembly approved the 16th day of
February, 1833, I have hereunto set my Hand and caused
the Seal of said Department to be affixed at Harrisburg,
this twentieth day of January 1911

Henry Howes

Secretary of Internal Affairs.